

OTS 210

For door leaf widths of 850 to 1100 mm



Product features

- Closing force sizes EN 2 / 3 / 4: sizes can be adjusted by moving the closer and turning the scissor-action arm bearing block
- Valve functions which can be steplessly adjusted from the front:
 - closing speed
 - latching speed
- Thermomatic valve ensures that the closing function continues to work in the event of temperature fluctuations
- Safety valve in the closer protects against overload
- Max. door opening and closing angle 180° [1]
- Controlled closing from every opening angle
- Compact, state-of-the-art aluminium housing
- Optional: adjustable hold-open arm for door openings of 70° and 150°

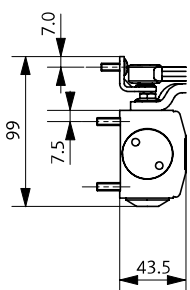
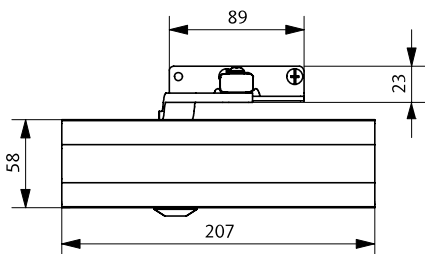

without mounting plate

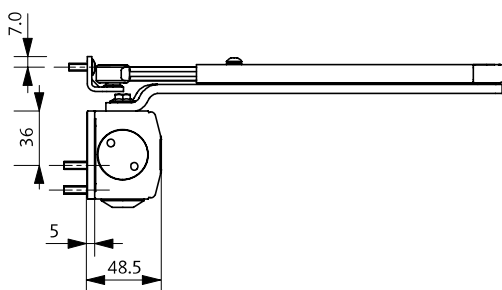

with mounting plate



06 2006-OTS-0002

EN 1154: 1996 + A1: 2002

