

# Fixing systems for grilles / diffusers

## Torsion spring fixing system SPRING

### SPRING

This system can be used to grilles type:

**SD, DD, SC, EGC-0, EGC-45, LD, PF, EGF, GAF**



This fixing system can be used for mounting on any plasterboard structure.

- 1) Lift the torsion spring and insert the grille in the opening hole.
- 2) Release the spring in order to fix the grille inside the plasterboard structure.

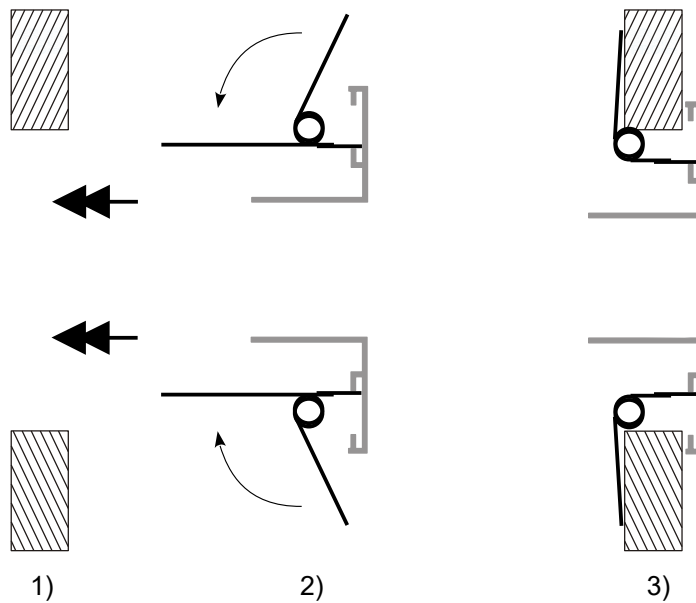

# Fixing systems for grilles / diffusers

## FIX system with mounting frame CC

### FIX+CC

This system can be used to grilles type:

**SD, DD, EGC-0, LD, GAF**

This system **cannot** be used to grilles type:

**SC, EGC-45, EGF, PF**

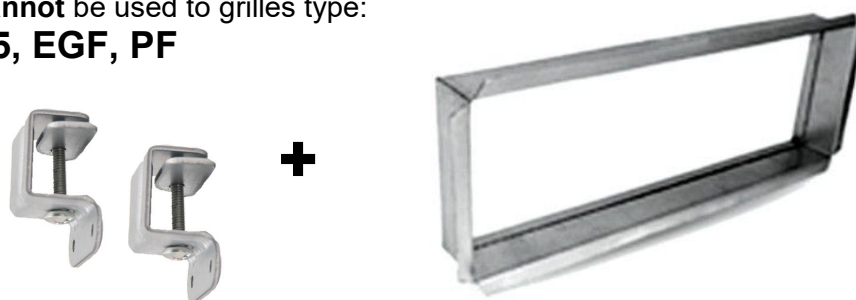

For mounting the CC frame of a grille with sizes LxH (mm), a opening hole with (L+5)x(H+5) mm is needed.

1) Fix the mounting frame CC to the structure with mechanical systems.

The manufacturer is not responsible if the installer does not choose the appropriate fixing method corresponding to the grille size and weight.

2) Insert the grille into the mounting frame and tighten the FIX system screws with a screwdriver.

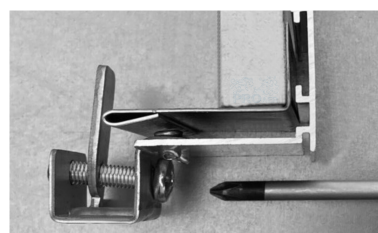
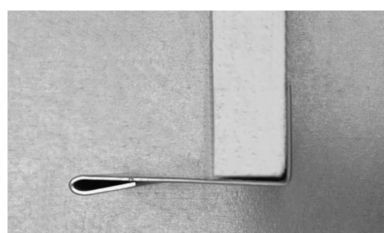
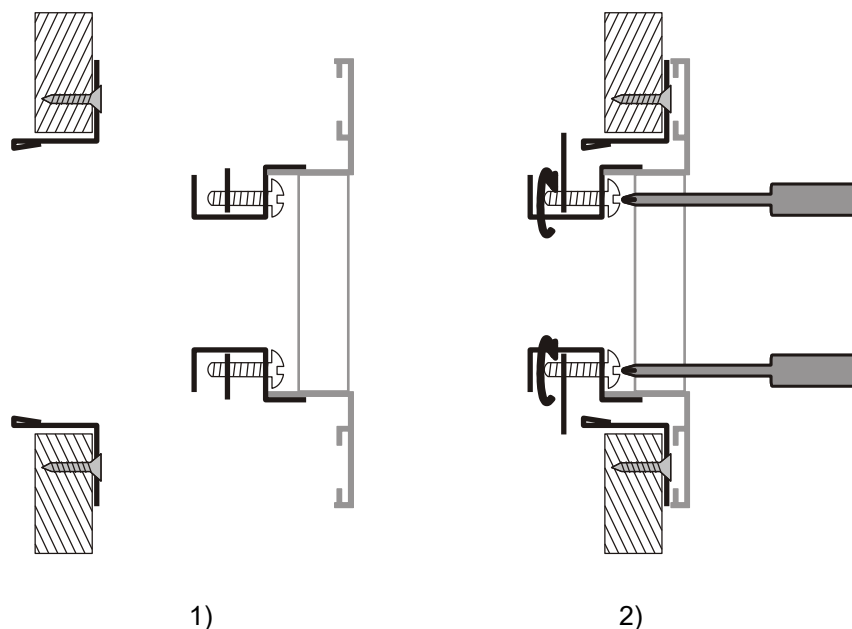

# Fixing systems for grilles / diffusers

## Spring CLIPS system with mounting frame CC

### CLIPS+CC

This system can be used to grilles type:

**SD, DD, SC, EGC-0, EGC-45, LD, PF, EGF**

**Note:** it is **STRICTLY FORBIDDEN** to use this system on the ceiling!

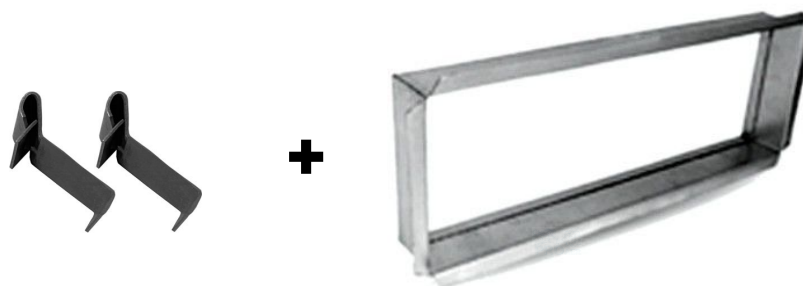

For mounting the CC frame of a grille with sizes LxH (mm), a opening hole with (L+5)x(H+5) mm is needed.

1) Fix the mounting frame CC to the structure with mechanical systems.

The manufacturer is not responsible if the installer does not choose the appropriate fixing method corresponding to the grille size and weight.

2) Insert the grille into the mounting frame.

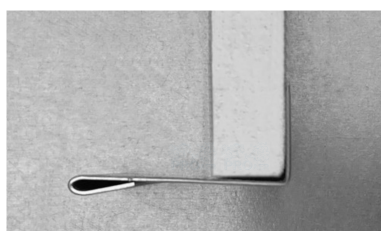
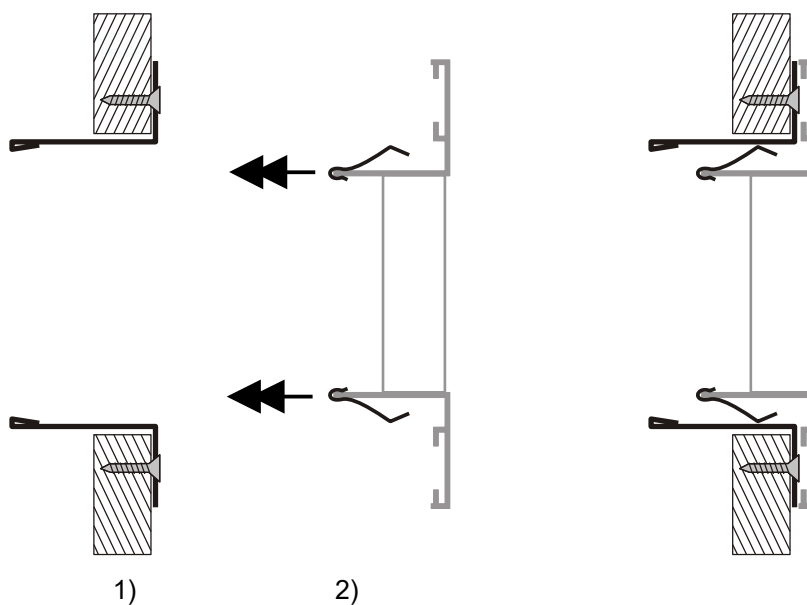

# Crossbar for slot diffusers

## BF / BF-D



### Specifications

Crossbar for slot diffuser mounting.

Delivery: crossbar BF/BF-D (1mm thickness) with 2 screws 4.2x50 (countersunk head).

**Order code:** **BF**

Product code	_____
no. of slots	_____

### Technical data

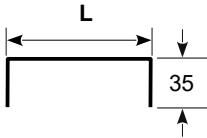

### Standard sizes

BF	
SLT	L
1 F	60
2 F	105
3 F	145
4 F	190

BF-D	
SLD	L
1 F	50
2 F	95
3 F	135
4 F	180

There are no other sizes available.

### Mounting

The mounting instructions are presented for each slot diffuser type in its datasheet.

# Crossbar for swirl diffusers

## BW



### Specifications

Crossbar for swirl diffusers mounting.

Delivery: crossbar BW, screw M6x80 (countersunk head).

Order code: **BW**

Product code \_\_\_\_\_

size SW....\*

\* size of the swirl diffuser

### Technical data

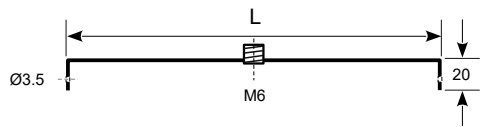

### Dimensiuni

Dimensiuni SW...	L	Recommended size (inside min~max) plenum*
625	580	(580~585)x(580~585)
595	550	(550~555)x(550~555)
500	450	(450~455)x(450~455)
400	360	(360~365)x(360~365)
300	260	(260~265)x(260~265)

\*depending on insulation thickness

There are no other sizes available.

### Montaj

**NOTE:** The crossbar is always supplied loose (not mounted in the plenum box). The mounting will be made by installer on site, depending on mounting conditions (depending on ceiling type).

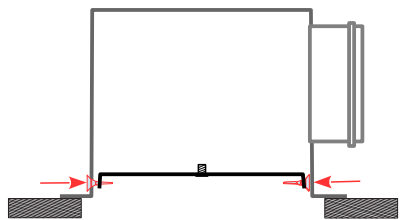

1. Adjust an fix crossbar **BW** to plenum

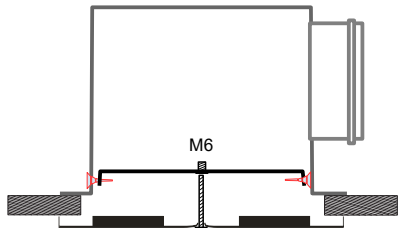

2. Attach the diffuser to the crossbar.

# Crossbar for circular diffusers

## BR



### Specifications

Crossbar for circular diffusers mounting.

Delivery: crossbar BR, 2 screws 4.2x50 (countersunk head).

Order code: **BR**

Product code      **BR**

circular diffuser size      \_\_\_\_\_

### Technical data

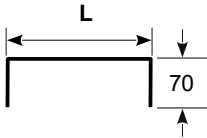

### Standard sizes

ØD	L
150	203
200	253
250	303
300	353
350	407
400	457
450	507
500	557

There are no other sizes available.