

MVE STANDARD RANGE



MICRO - 3000/3600 rpm



THREE-PHASE

Wm (kgcm)		Model		Centrifugal Force (kg)		Weight (kg)		ELECTRICAL SPECIFICATIONS						CERTIFICATE	
								Input Power (kW)		Nominal Current A max			Cable Gland	For 60Hz	For 50Hz
50Hz	60Hz	50Hz	60Hz	50Hz	60Hz	50Hz	60Hz	50Hz (230V)	50Hz (400V)	60Hz (460V)	Metric	Class II Div.2		II3D	
0.40	0.40	MICRO 21		20	29	2		0.04	0.04	0.16	0.12	0.12	M16	T4	100°C
0.90	0.90	MICRO 41		45	65	2.4		0.06	0.06	0.30	0.18	0.18	M16	T4	100°C

SINGLE-PHASE

Wm (kgcm)		Model		Centrifugal Force (kg)		Weight (kg)		ELECTRICAL SPECIFICATIONS						CERTIFICATE	
								Input Power (kW)		Nominal Current A max			Cable Gland *	For 60Hz	For 50Hz
50Hz	60Hz	50Hz	60Hz	50Hz	60Hz	50Hz	60Hz	50Hz (230V)	60Hz (115V)		Metric	Class II Div.2		II3D	
0.08	0.08	MICRO 3 M		4	6	1.6		0.03	0.04	0.30	0.80	M16	T4	100°C	
0.12	0.12	MICRO 6 M		6	9	1.6		0.03	0.04	0.30	0.80	M16	T4	100°C	
0.40	0.40	MICRO 21 M		20	29	2		0.04	0.07	0.20	0.80	M16	T4	100°C	
0.90	0.90	MICRO 41 M		45	65	2.4		0.05	0.07	0.25	0.80	M16	T4	100°C	

* NOTE: Capacitor integrated in the cable

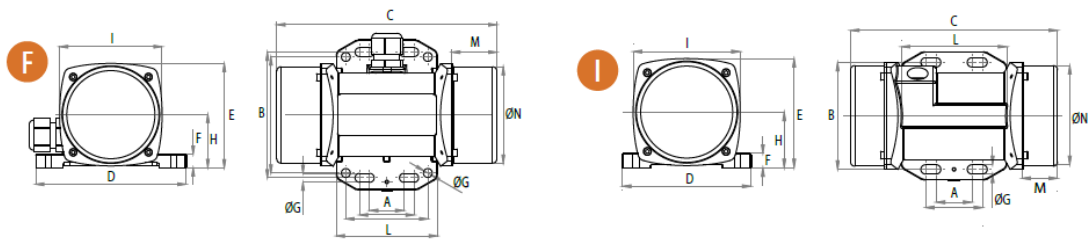

Model		Drawing	DIMENSIONAL SPECIFICATIONS (mm)												
			C	M	A	B	ØG	Holes	D	E	F	H	I	L	N
50Hz	60Hz		50Hz	50Hz				N°							
MICRO 21/3	F	145	25	Multiple Footprint			4	110	76.5	10	39	75	74	70.5	
				25-40	92	6.5									
				60	85	6.5									
MICRO 41/3	F	161	33	Multiple Footprint			4	110	76.5	10	39	75	74	70.5	
				25-40	92	6.5									
				60	85	6.5									

Motor Name		Drawing	DIMENSIONAL SPECIFICATIONS (mm)												
			C	M	A	B	ØG	Holes	D	E	F	H	I	L	N
50Hz	60Hz		50Hz	50Hz				N°							
MICRO 3/3 M	F	145	25	Multiple Footprint			4	110	76.5	10	39	75	74	70.5	
				25-40	92	6.5									
				60	85	6.5									
MICRO 6/3 M	I	145	25	Multiple Footprint			4	90	76.5	10	39	75	74	70.5	
				25-40	75	6.5									
				-	-	-									
MICRO 21/3 M	F	145	25	Multiple Footprint			4	110	76.5	10	39	75	74	70.5	
				25-40	92	6.5									
				60	85	6.5									
MICRO 41/3 M	F	161	25	Multiple Footprint			4	110	76.5	10	39	75	74	70.5	
				25-40	92	6.5									
				60	85	6.5									