



WALL MONITOR MOUNTS



FEATURES

- Increased flexibility of 2 axis of rotation
- 360° rotation for portrait or horizontal screen option
- Under arm cable management

TECHNICAL



min.
75x75 mm
max.
100x100 mm



19"-27"



10 kg



110°/110°



min.
75x75 mm
max.
100x100 mm



min. 108 mm
max. 472 mm



180°



360°

PRODUCT SPECIFICATION

| Dimensions (HxWxD) | Weight | Max capacity | Colour | Packaging dimensions |
|--------------------|---------|--------------|--------------|----------------------|
| 783x800x500 mm | 1,95 kg | 10 kg | black silver | 810x280x950 mm |

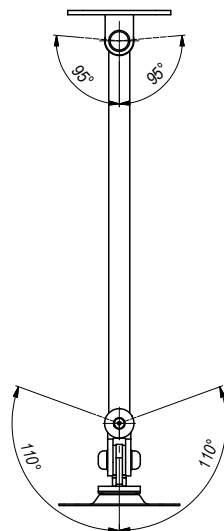
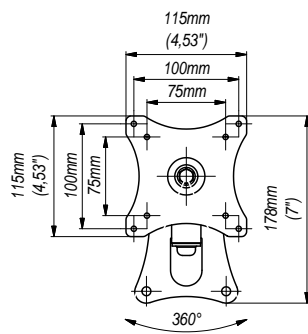

TECHNICAL DRAWINGS

