

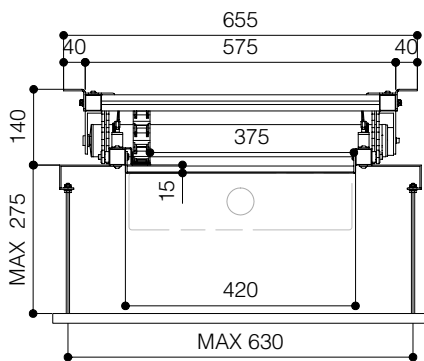

The **PROJECTOR LIFT SI-H 100** is studied in order to support large and heavy video projectors up to 30 Kg. of weight. The SI-H 100 is supplied with an extremely silent motor that allows a descent from a minimum of 14 cm. to a maximum of 97 cm. Moreover it is supplied with extendable side brackets in order to allow an easy fixing of the panel of your false ceiling by adjustable threaded bars. The panel can be mounted under the projector, even if the projector is larger as the lift itself. The lift SI-H 100 is equipped with two **safety screws** that prevent the lift to extent further to the preset end stop.

\* Ceiling cover plate is NOT included

Frontal view closed



Side view closed

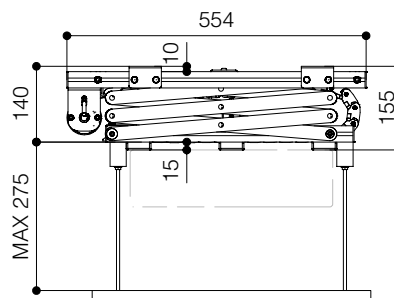

Side view open

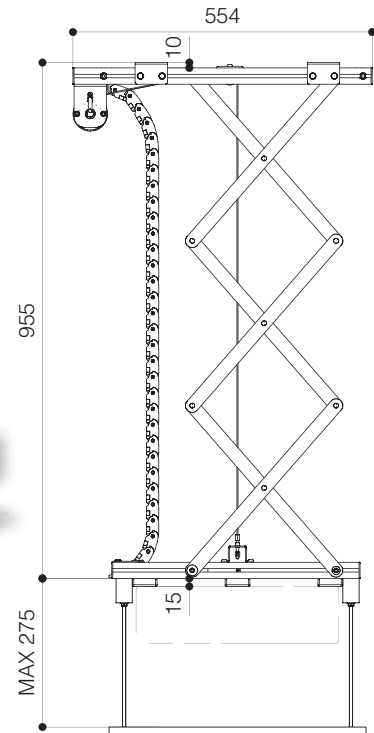

Maximum size fixing points projector

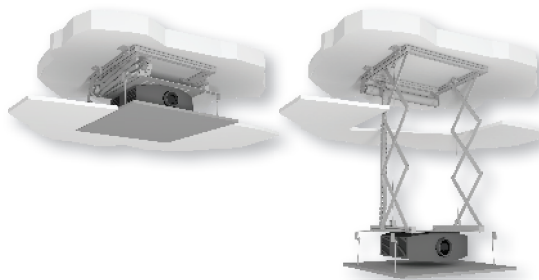
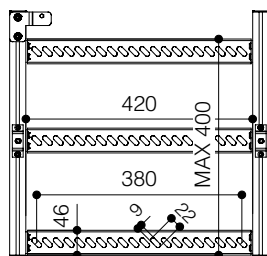

**Optionals:**

- Ceiling tile holder (details p. 64)
- Kit RF remote control with external receiver (details p. 62)
- Interface switch 12 volt (details p. 63)
- Low voltage contact interface (details p. 62)

### TECHNICAL SPECIFICATIONS

|                                      |                           |
|--------------------------------------|---------------------------|
| POWER SUPPLY                         | 220-230V - 50HZ           |
| MAXIMUM CONSUMPTION                  | 184 W                     |
| TORQUE                               | 20 Nm                     |
| MOTOR SPEED                          | 17 rpm                    |
| MINIMUM DIMENSIONS LIFT CLOSED       | 575x155x554 (WxHxD in mm) |
| DIMENSIONS LIFT OPENED               | 575x970x554 (WxHxD in mm) |
| MAXIMUM SIZE FIXING POINTS PROJECTOR | 380x400 (WxD in mm)       |
| MAXIMUM OVERALL SIZE OF PROJECTOR    | 570x600 (WxD in mm)       |
| MAXIMUM LOAD                         | 30 Kg                     |
| NET WEIGHT OF THE PROJECTOR LIFT     | 12 Kg                     |
| CABLE GATHERING SYSTEM               | 20x18 (WxH in mm)         |

The measures in the drawings are expressed in millimetres.

**Warranty:** 5 years on the motor - 24 months on the other components

**ENGINEERED LIKE NO OTHER SCREEN IN THE WORLD**