



Specification of: RWM 57-5056-4W-17

Smoke extract wall fan murovent with external HIGH EFFICIENCY motor in efficiency class IE 2 (IEC 60034-30)

with horizontal discharge suitable for smoke extraction in the case of fire for temperatures up to +600 °C, 120 min. Tested and certified to DIN EN 12101-3 - Certificate No 0036-CPR-RG01-17. Casing made of rugged galvanised steel sheet. Intake cone made of galvanised steel sheet and with connection to flange acc. to DIN 24155-2 Discharge with guard. Backward curved impeller of welded, coated sheet steel construction, All parts under mechanical stress made of galvanised steel oder painted. Motor completely out of hot gas area and cooled by

outside air. Feed line loose cable to motor connection box.

Technical data of the fan: RWM 57-5056-4W-17

EU regulation 1253/2014 not applicable

| Description | Value Dimension |
|---|--|
| Specified duty point | |
| Air flow rate (V) | 12690 m ³ /h |
| Static pressure rise (dp _{ra}) | 159 Pa |
| Actual duty point | |
| Installation acc. DIN 24163 Part 1 | A |
| Reference density (Rho1) | 1.15 kg/m ³ |
| Medium temperature (t) | 20 C |
| Air flow rate (V) | 12813 m ³ /h |
| Static pressure increase (dp _{ra}) | 162 Pa |
| Fan weight | 134 kg |
| A-weighted sound power level discharge/intake LwA _{B/-} | 96/- dB |
| Unweighted octave sound power level | Octave mid frequencies ¹⁾ 63/125/250/500/1k/2k/4k/8k Hz 85/94/92/90/91/90/85/79 dB discharge LwOkt _s |
| <small>SOUND PRESSURE levels at 1/2/3 m distance can be calculated with free sound propagation approximately by reducing the SOUND POWER level by 11/17/20 dB !</small> | |
| <small>¹⁾ The octave sound power levels can be higher at octave bands at or close to blade passing frequency.</small> | |
| Rated data | |
| Phases-Voltage-Frequency | 3~230/400-50 V-Hz |
| Frame size-poles: | 100Lb / IE2-4 |
| Motor rating (P _N) | 3 kW |
| Rated motor speed (n _N) | 1455 min ⁻¹ |
| Rated motor current (I _N) | 10,7/6,2 A |
| Max. temperature t _{max} , admitted for 120 min only | 600 C |
| operational limits | |
| Max. fan speed (n _{vmax}) | 1500 min ⁻¹ |
| Max. operating frequency (f _{max}) | 50 Hz |
| Temperature range of conveying medium (t _{min} ...t _{max}) | -20...80 C |

Fan curve to RWM 57-5056-4W-17

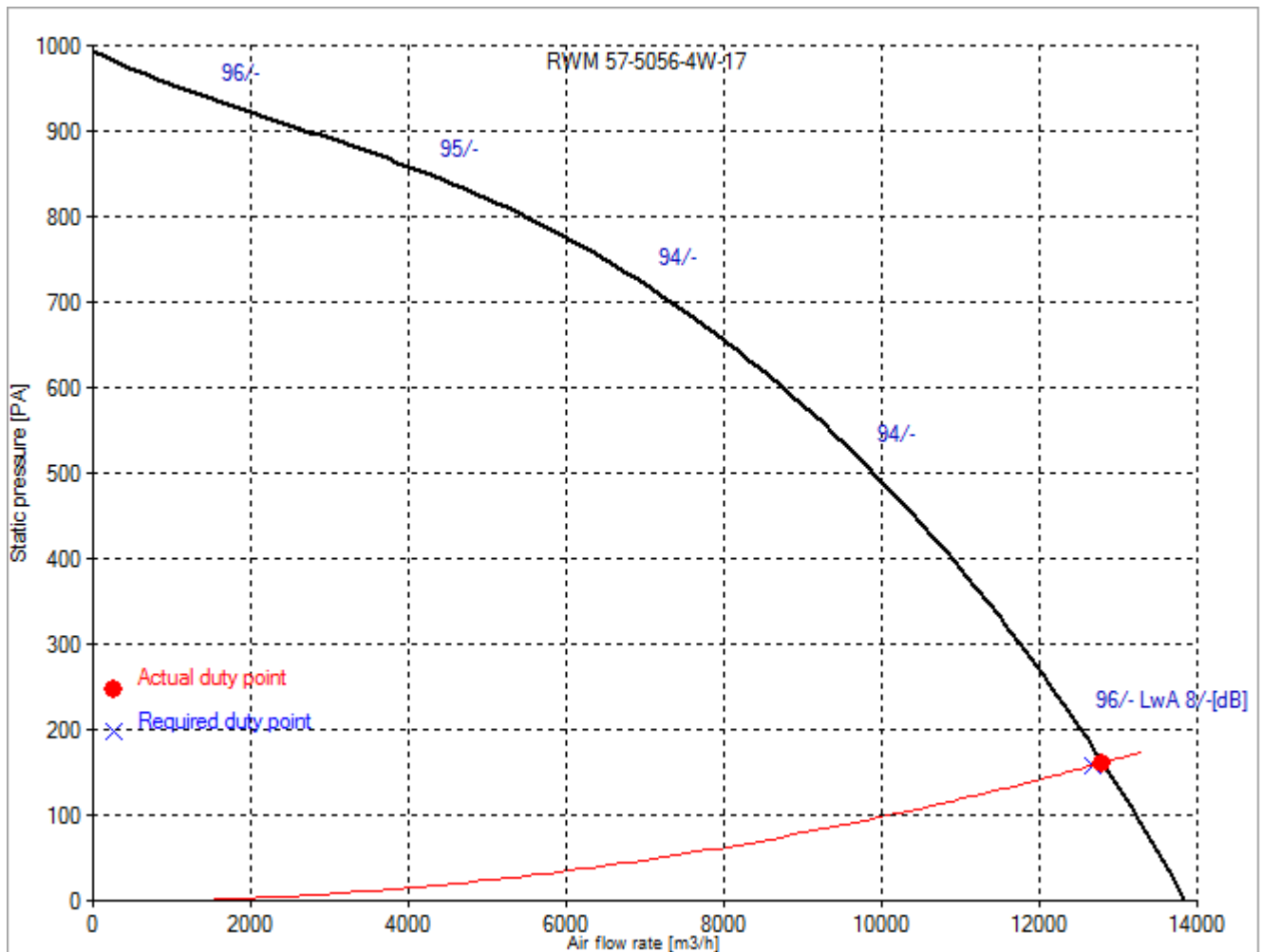

Dimensions to RWM 57-5056-4W-17

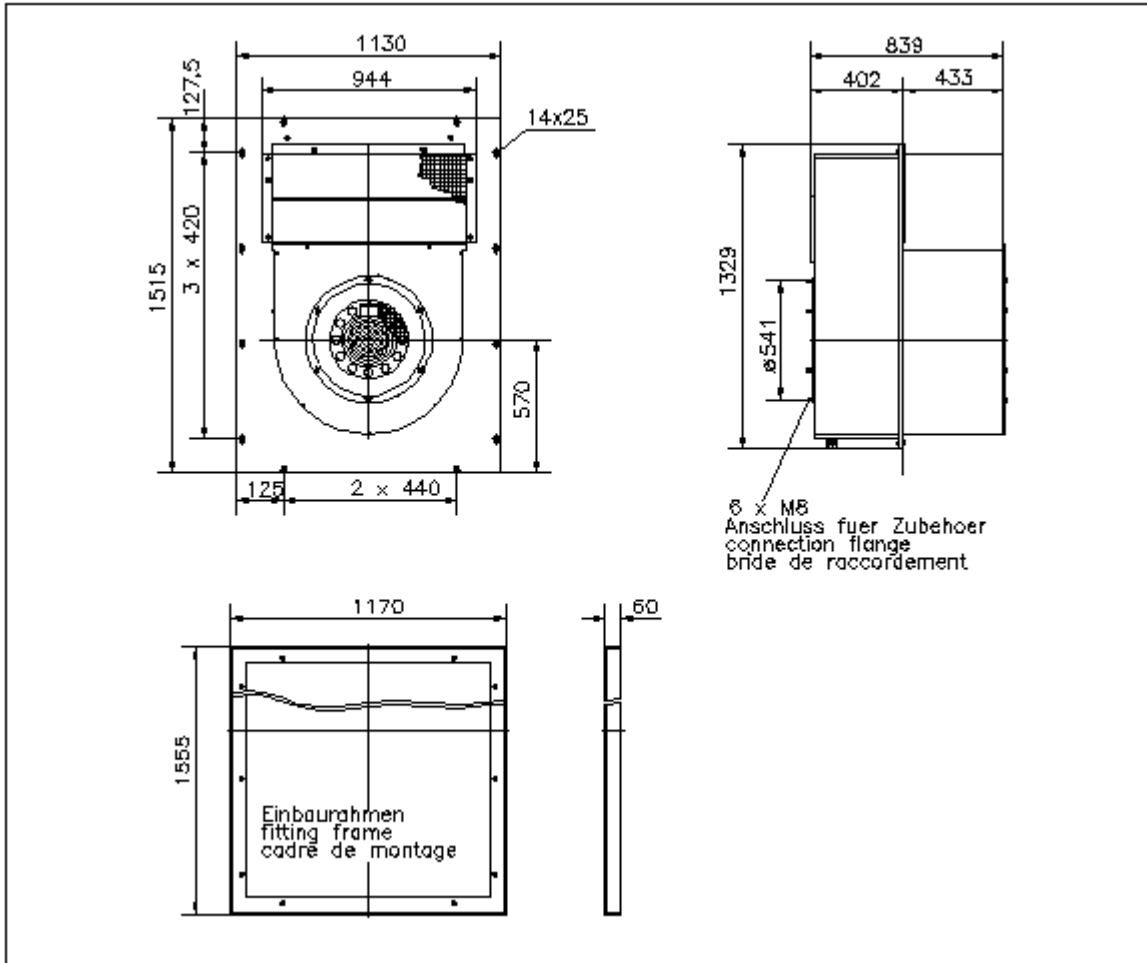

Rotation:
Handing:

RD
90